

C.A.T.

ULTRACAT SERIES POULTRY INJECTORS

MEPSCO



*Hinged, tilt-back
airhead manifold for
easy access.*

*Brine tank with self-cleaning
filtration system.*

ULTRACAT-244 and ULTRACAT-488 Injectors for unmatched high-speed performance and maximum yields.

MEPSCO's world leadership is reflected in its highly versatile ULTRACAT Series' 244 and 488 Injectors.

Built right from the start, they set the pace for the controlled marination of whole chickens and bone-in and boneless poultry products.



Proven in poultry plants, these highly reliable injectors provide maximum yields on impact-resistant, extra-wide 31-1/2" conveyor belts, with production rates up to 20,000 pounds (6,600 whole chickens) an hour. Each injector, with 244 or 488 stainless steel needles, delivers 3% to 30% in a single pass with uni-

form distribution, best moisture retention, and superior piece-to-piece accuracy sustained hour after hour.

The reliable ULTRACAT Injectors feature polished stainless steel exterior, programmable touch screen, and high output brine pump. Self cleaning, efficient filtration system has wedge-wire rotary drum and dual in-line pressure filters for trouble-free operation. Plus an easy tilt-back airhead manifold for easy needle removal and cleaning.

MEPSCO backs its ULTRACAT Series Injectors with the industry's strongest customer support and extended services. These programs continue long after a high-speed ULTRACAT-244 or ULTRACAT-488 POULTRY INJECTOR GOES ON LINE.

SPECIFICATIONS

Applications: ULTRACAT Series Injectors for marinating whole and cut-up, bone-in and boneless, chicken and turkey products.

Product capability: ULTRACAT-244 with rates up to 65 chickens a minute. ULTRACAT-488 with rates up to 110 chickens a minute.

Sizes: Normal length 127.7". Overall width 72.8" with brine tank. Height 84". Approximate weight 2,800 pounds.

Transport System: Impact resistant, acetal plastic-link conveyor belt, flights optional, with overall length of 11' or customer-specified longer length.

Bed and clearance: Extra-wide 31.5" conveyor bed and up to 8" product needle head clearance.

Needles: Injectors with 244 or 488 special alloy stainless steel, available in .118" (3mm), 158" (4mm) or .188" (5mm) diameter, with removable caps for easy cleaning.

Injector speed: Fully adjustable on touch screen control panel up to 70 strokes-per-minute.

Injection range: 3% to 30% or more in single pass, dependent on product.

Control panel: Touch screen panel for setting and displaying all injector functions, speed, pressure, brine temperature, belt index, diagnostics and trouble-shooting.

Hydraulic power pack: 24 gallon capacity. 10 hp vane hydraulic pump. Normal 1,000 PSI working pressure.

Brine pump: Centrifugal with 6.5" diameter stainless steel impeller. 160 gpm at 60 PSI. 10 hp motor. Pressure adjustment via variable frequency drive, maximum to 70 PSI (4.8 bar).

Brine holding tank: 50 gallon normal working capacity, with built-in float valve.

Five-stage brine filter: Self-cleaning with wedge-wire rotary drum with .020" wire slots, waste auger, spray nozzles, two stainless steel mesh screens in tank, and dual final in-line filters.

Electrical control: Electrical motor controls contained in sealed enclosure with easy access door.

Utilities requirements: Electrical - main line power supply for total 20 hp at 460V (30 amp), three-phase 60 HZ or 230V (60 amp). Air - 3/8" with quick disconnect. 1" brine connection.

Construction: Heavy gauge 304 polished #4 stainless steel exterior and heavy-duty materials.

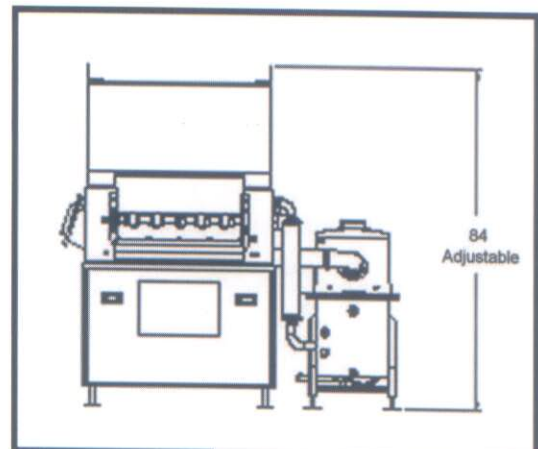
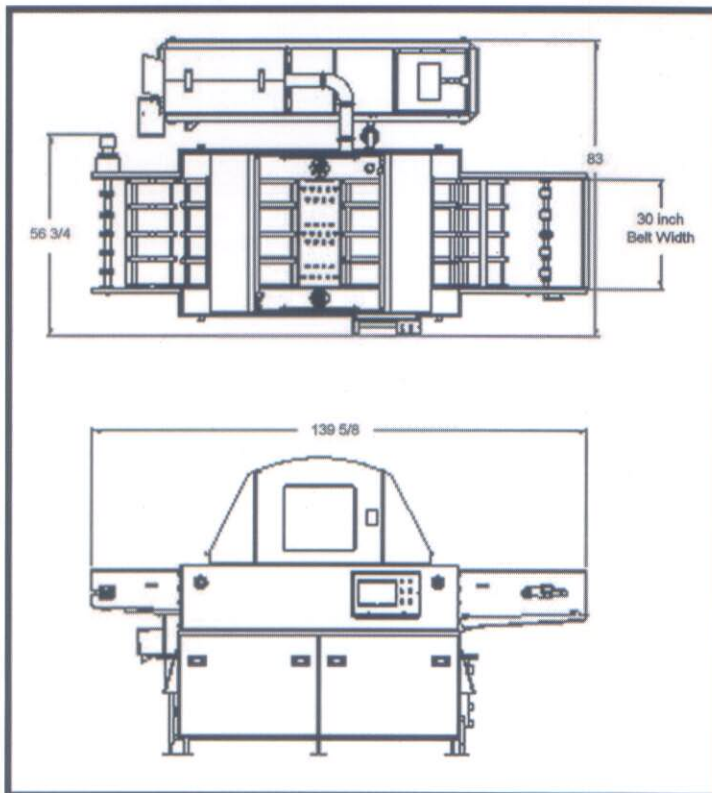
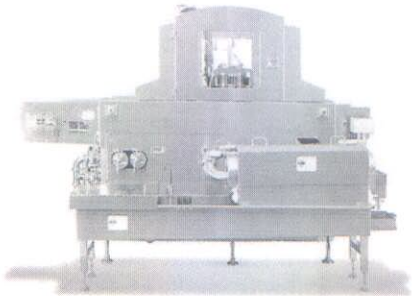

C.A.T.

You Deserve
Value!

www.gocatgo.biz
info@gocatgo.biz

MEPSCO