

C.A.T.

ULTRACAT 140/280 INJECTORS

MEPSCO

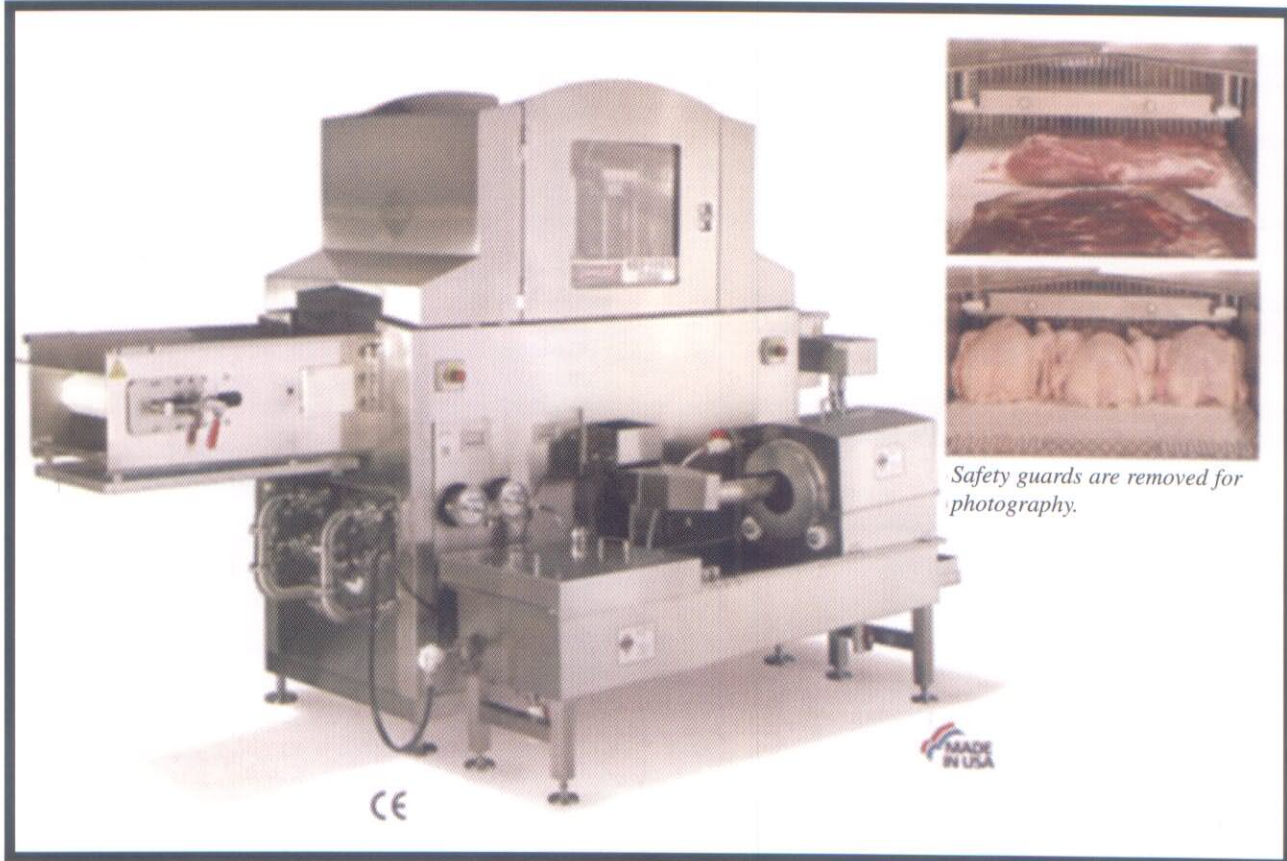

ULTRACAT-140 and ULTRACAT-280 Injectors for unmatched high-speed performance and maximum yields.

MEPSCO's world leadership is reflected in its versatile ULTRACAT-140 and 280 Injectors. Designed, right from the start, they set the pace for the controlled injection of bone-in and boneless meats such as whole hams and picnics, loins, pork bellies, and other pork and beef products. And marinating whole turkeys and chickens, cut-up poultry parts, fresh steaks and park, and seafood.



Engineered for superior performance, these highly reliable injectors provide maximum yields on impact-resistant 18" wide conveyor belts. Production rates are up to 12,000 pounds an hour. Each injector, with 140 or 280 stainless steel needles,

delivers 3% to 85% in a single pass with uniform distribution, best moisture retention, and superior piece-to-piece accuracy, hour after hour.

These rugged ULTRACAT Injectors feature polished stainless steel exteriors, programmable touch screens, and high output brine pumps. Efficient, self-cleaning filtration system has wedge-wire rotary drum and dual in-line pressure filters for trouble-free operation. Plus a tilt-back airhead manifold for easy needle removal and cleaning.

MEPSCO backs its systems with the industry's strongest customer support and extended services. These programs continue long after an ULTRACAT-140 or ULTRACAT-280 goes on line.

SPECIFICATIONS

Applications: Injecting bone-in and boneless meats such as hams, picnics, loins, pork bellies and beef products. Marinating whole turkeys and chickens, cut-up poultry, fresh steaks and pork, and seafood.

Product capacity: ULTRACAT-140 with production rates up to 6,000 pounds an hour. ULTRACAT-280 with production rates up to 12,000 pounds an hour.

Sizes: Normal length 120-3/8". Overall width 61" with brine tank. Height 84". Approximate weight 2,900 pounds.

Transport System: Impact resistant, acetal plastic-link conveyor belt, with overall length of 111" or customer-specified longer length.

Bed and clearance: 18" wide conveyor bed and up to 8" product needle head clearance.

Needles: Injectors with 140 or 280 special alloy stainless steel, available in .118" (3mm), 158" (4mm) or .188" (5mm) diameter, with removable caps for easy cleaning.

Injector speed: Fully adjustable on touch screen control panel up to 50 strokes-per-minute, with 2" to 8" index synchronized with needle head.

Needle activation valve: Choice of individual needle activation on contact or one-way (down stroke) or two-way full flow (up and down stroke).

Injection range: 3% to 85% in single pass, dependent on product.

Control panel: PLC touch screen panel (pre-wired) for setting and displaying injector functions, speed, pressure, brine temperature, head height, belt index, diagnostics and trouble-shooting.

Hydraulic power pack: 24 gallon capacity. 7.5 hp with variable displacement pump. Normal 1,800 PSI working pressure.

Brine pump: Centrifugal with 5.5" diameter stainless steel impeller. 80 gpm at 60 PSI. 10 hp motor. Pressure adjustment via variable frequency drive, maximum to 70 PSI (4.8 bar).

Brine holding tank: 50 gallon normal working capacity, with built-in float valve.

Five-stage brine filter: Self-cleaning with wedge-wire rotary drum with .020" wire slots, waste auger, spray nozzles, three stainless steel mesh screens in tank, and dual final in-line filters.

Electrical control: Electrical motor controls contained in sealed NEMA 4X enclosure with easy access door.

Utilities requirements: Electrical - main line power supply for total 10 hp at 460V (20 amp), three-phase 60 HZ or 230V (40 amp). Air - 3/8" with quick disconnect. 1" brine connection.

Construction: Heavy gauge 304 polished #4 stainless steel exterior and heavy-duty materials.

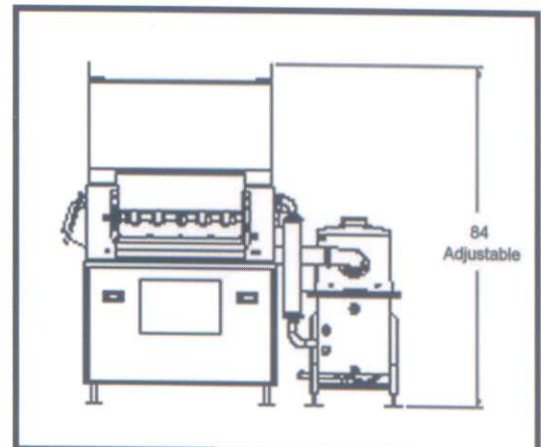
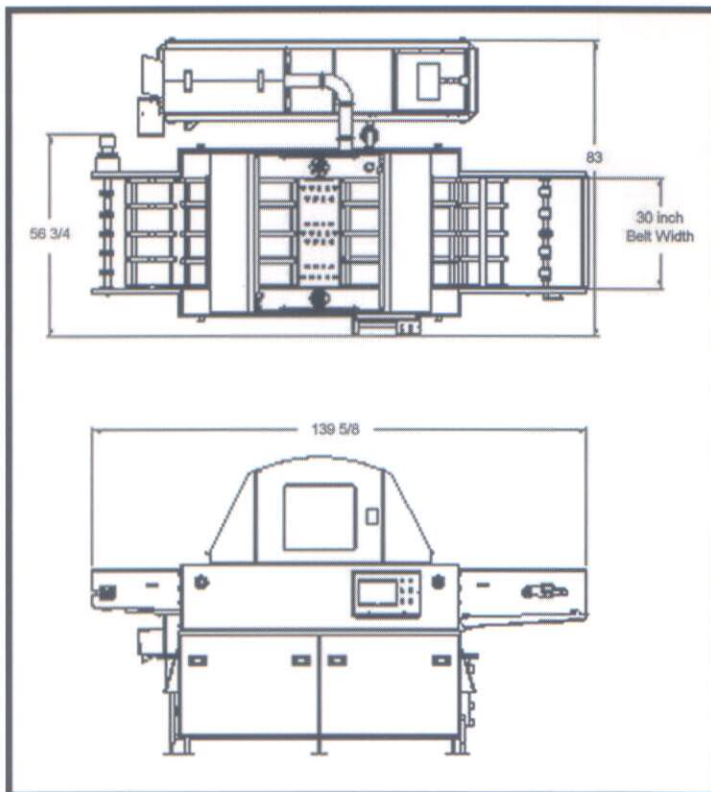

C.A.T.

You Deserve
Value!

www.gocatgo.biz
info@gocatgo.biz

MEPSCO